

# HD EUROPEAN TUBULAR

## HD-SERIES (THRU-BOLT)



PASSAGE T100/T101 2<sup>3</sup>/<sub>8</sub>" OR 2<sup>3</sup>/<sub>4</sub>" BACKSET

PRIVACY T140/T141 2<sup>3</sup>/<sub>8</sub>" OR 2<sup>3</sup>/<sub>4</sub>" BACKSET

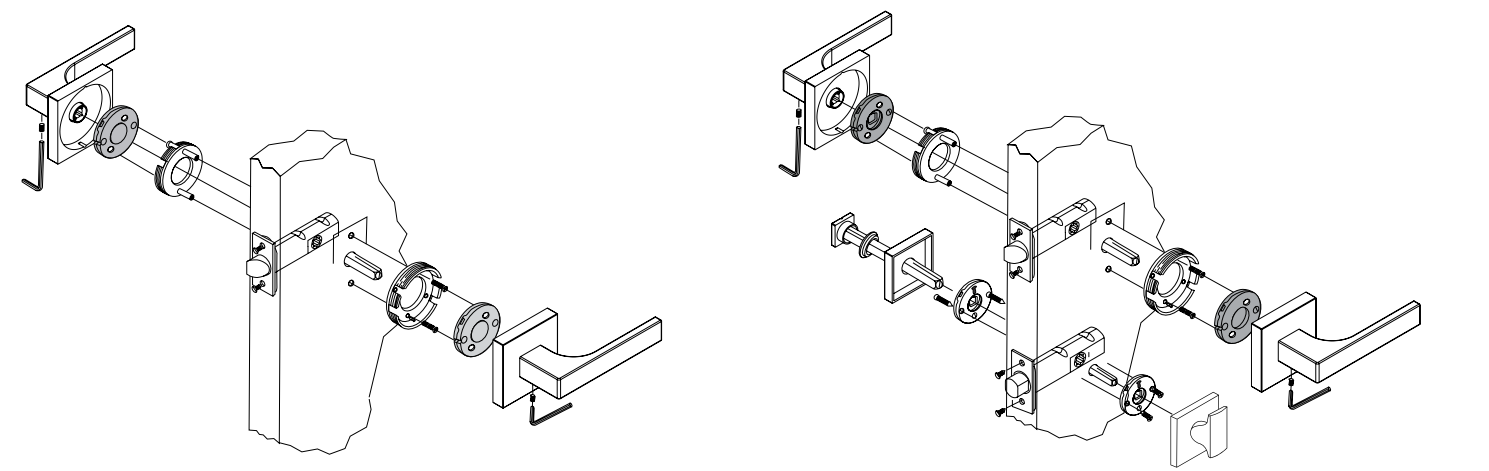

KEYLOCK T150/T151 2<sup>3</sup>/<sub>8</sub>" OR 2<sup>3</sup>/<sub>4</sub>" BACKSET

DOUBLE DUMMY D190

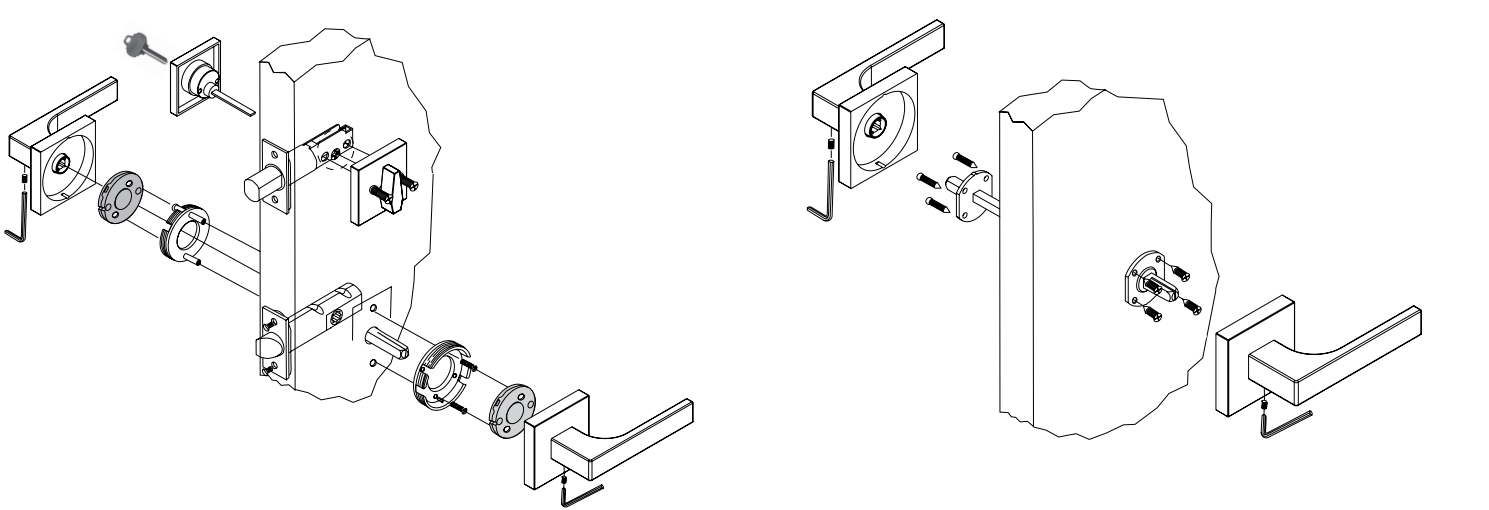

SINGLE DUMMY D185

Sample Specification  
 for a "ROBOCINQUES" HD-Euro-Tubular 2<sup>3</sup>/<sub>4</sub>" backset privacy  
 Lever - ID71 HD-T141 - Satin Chrome  
 Function      └───┐  
 Finish      └───┐

TUBULAR LATCHES AVAILABLE IN 2<sup>3</sup>/<sub>8</sub>" OR 2<sup>3</sup>/<sub>4</sub>"BACK-SET.  
 THEY ARE NOT ADJUSTABLE.

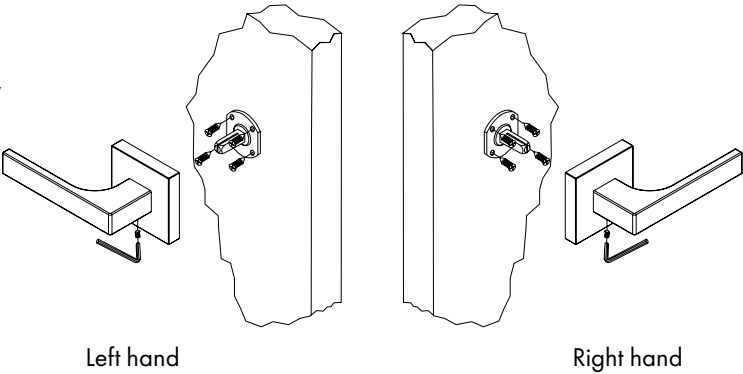

**PLEASE NOTE**

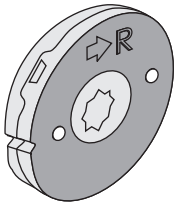

**Metal Springs are handed**

Handing is indicated with arrow pointing to hinge location, also with either an "R" for right or "L" for Left.

**FACE PLATE**

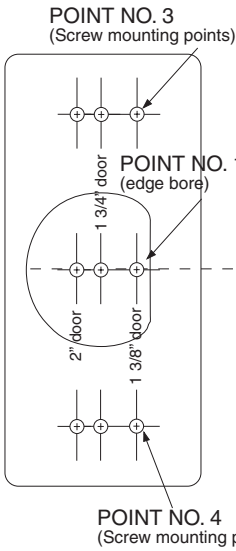

Fold on dotted line - Lay over edge of door.

**IMPORTANT:  
READ ALL INSTRUCTIONS CAREFULLY  
BEFORE PREPARING DOOR  
PASSAGE LATCH TEMPLATE**

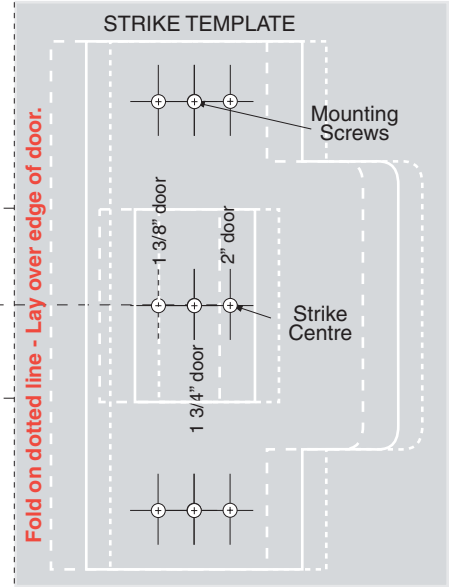
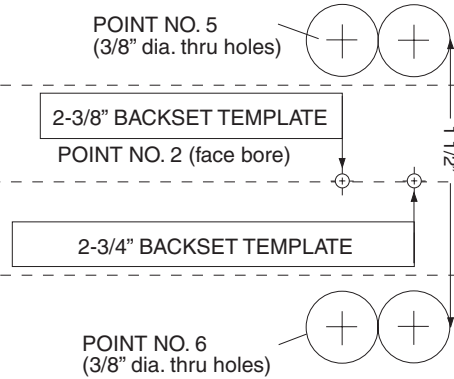

**PARTS INCLUDED WITH YOUR NEW PASSAGE**

**Passage Parts**

1. Right Hand Lever Handle (inside)
2. Allen Key
3. Handle Set Screw (2)
4. Metal Spring Pack (Left Hand inside Shown)
5. Male Screws (inside)
6. Sub Mounts (inside)
7. Passage Spindle
8. Passage Latch (inside)
9. Face Plate
10. Face Plate Screws (2)
11. Sub Mounts (outside)
12. Female Screws (outside)
13. Metal Spring Pack (outside)
14. Left Hand Lever Handle (outside)

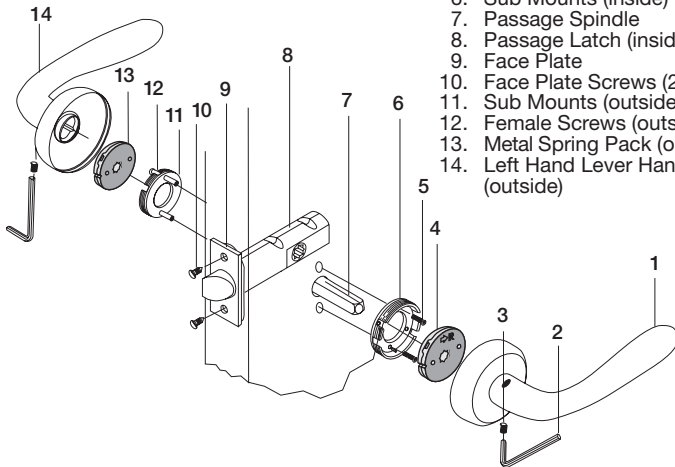

**Passage Latch & Strike**

**Passage Strike**

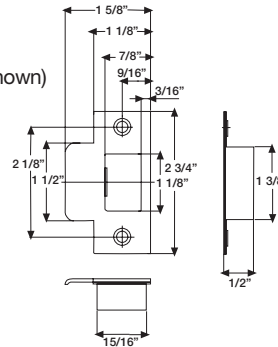

**Passage Latch**

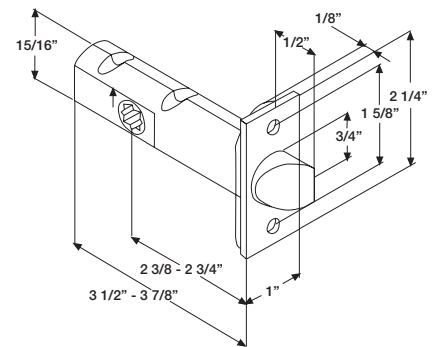

**TOOLS REQUIRED:**

Drill, 1" dia. bit, 5/8" dia. bit, 3/8" dia. bit, 1/8" dia. bit,  
Center Punch, Chisel, Hammer, Phillips Screwdriver.  
**BE SURE TO READ ALL INSTRUCTIONS  
BEFORE PREPARING DOOR.**

**1. Position Template**

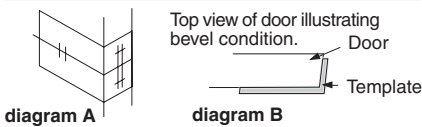

Determine latch backset (2-3/8" or 2-3/4").  
Fold enclosed template on dotted line and locate on door at desired height (diagram A).  
If door is bevelled (see diagram B), place folded edge on low side of bevel as shown above.

**2. Mark Door**

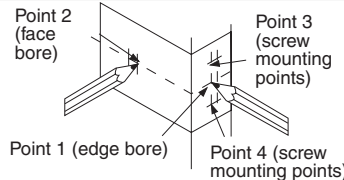

Mark door at points No. 1, No. 2, No. 3, and No. 4 and center punch for drilling.

**3. Drill Edge Bore**

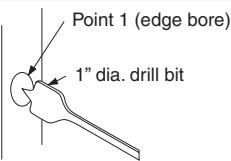

Drill 1" dia. hole.  
2-3/8" backset.... **drill 3-5/8" deep.**  
2-3/4" backset.... **drill 4" deep.**

**4. Drill Face Bore**

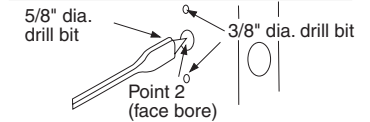

Keep drill perpendicular to door surface and drill through.  
**Note for wood doors:** to avoid splintering, drill a centering hole through the door, then drill face bore from both sides.

**5. Position Faceplate**

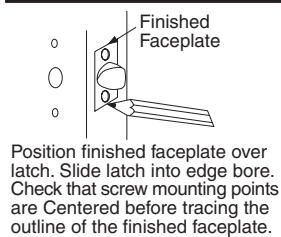

Position finished faceplate over latch. Slide latch into edge bore. Check that screw mounting points are centered before tracing the outline of the finished faceplate.

**6. Chisel Mortise**

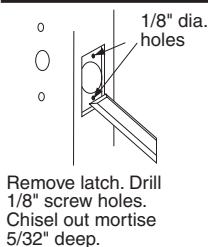

Remove latch. Drill 1/8" screw holes. Chisel out mortise 5/32" deep.

**7. Insert Latch**

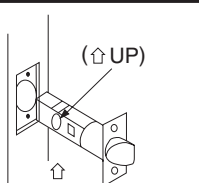

With "UP" side up, slide latch into edge bore.

**8. Attach Faceplate**

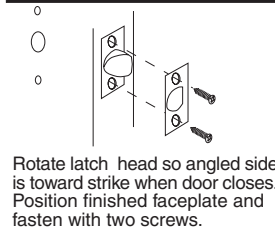

Rotate latch head so angled side is toward strike when door closes. Position finished faceplate and fasten with two screws.

**9. Install Strike**

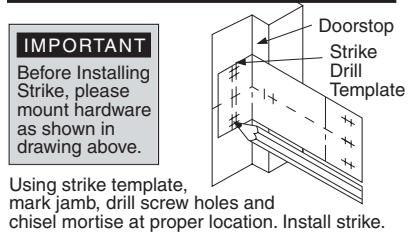

**IMPORTANT**  
Before Installing Strike, please mount hardware as shown in drawing above.

Using strike template, mark jamb, drill screw holes and chisel mortise at proper location. Install strike.

**NOTE: Check to ensure face plate does not restrict free movement of the latch head. Install trim.**

**Template #009 - RH**

# Installation Instructions for HEAVY DUTY PRIVACY LOCK HD T140 - T141 - non-bored door condition

## TOOLS REQUIRED:

Drill, 1" dia. bit, 5/8" dia. bit, 3/8" dia. bit, 1/8" dia. bit, Center Punch, Chisel, Hammer, Phillips Screwdriver.  
BE SURE TO READ ALL INSTRUCTIONS BEFORE PREPARING DOOR.

### PLEASE NOTE



### Metal Springs are handed

Handing is indicated with arrow pointing to hinge location, also with either an "R" for RIGHT or "L" for LEFT.

### Passage Latch & Strike

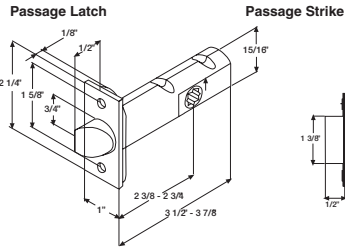

### Privacy Bolt & Strike

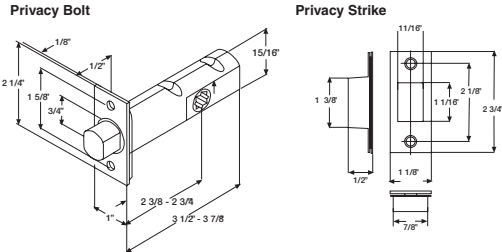

### PARTS INCLUDED WITH YOUR NEW PRIVACY LOCK

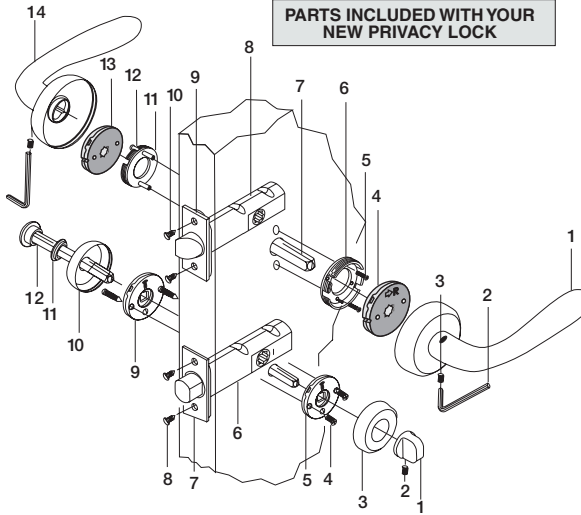

#### Passage Parts

1. Right Hand Lever Handle (inside)
2. Allen Key
3. Handle Set Screw (2)
4. Metal Spring Pack (Right Hand inside Shown)
5. Male Screws (inside)
6. Sub Mounts (inside)
7. Passage Spindle
8. Passage Lath (inside)
9. Face Plate
10. Face Plate Screws (2)
11. Sub Mounts (outside)
12. Female Screws (outside)
13. Metal Spring Pack (outside)
14. Left Hand Lever Handle (outside)

#### Privacy Parts

1. Thumb turn (inside)
2. Thumb turn Set Screw
3. Rose (inside)
4. Screws #4 (4)
5. Springless Back (inside)
6. Privacy Bolt
7. Face Plate
8. Face Plate Screws (2)
9. Springless Back (outside)
10. Rose
11. Washer
12. Emergency Release spindle

### FACE PLATE

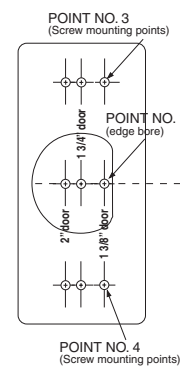

### FACE PLATE

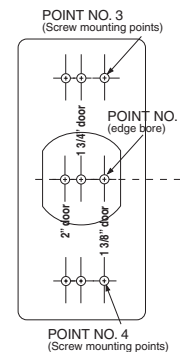

### PASSAGE LATCH TEMPLATE

IMPORTANT:  
READ ALL INSTRUCTIONS CAREFULLY  
BEFORE PREPARING DOOR

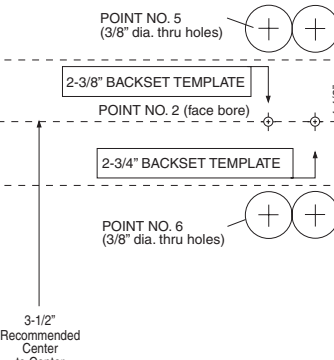

### PRIVACY MORTISE BOLT TEMPLATE

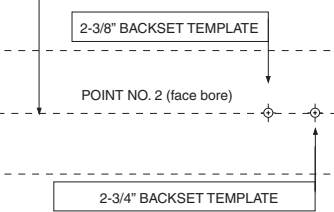

### STRIKE TEMPLATE

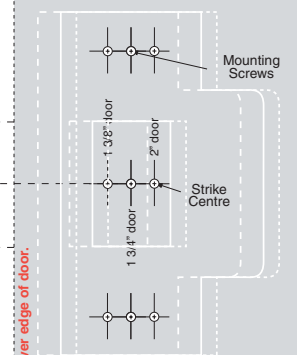

### STRIKE TEMPLATE

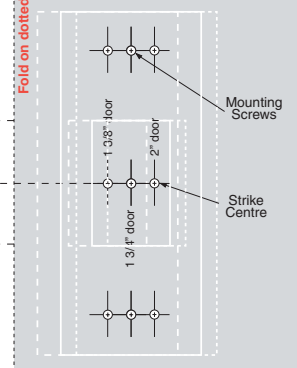

### 1. Position Template

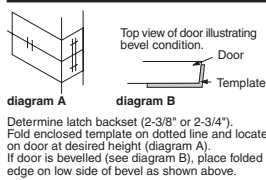

### 2. Mark Door

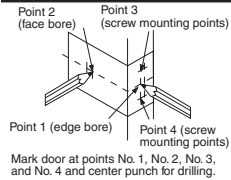

### 3. Drill Edge Bore

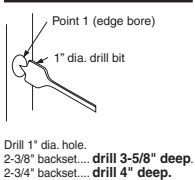

### 4. Drill Face Bore

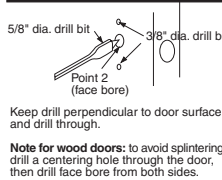

### 5. Position Faceplate

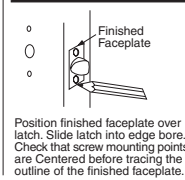

### 6. Chisel Mortise

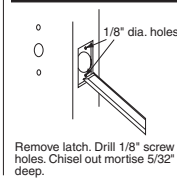

### 7. Insert Latch

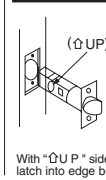

### 8. Attach Faceplate

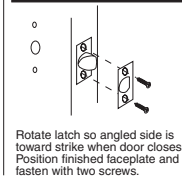

### 9. Install Strike

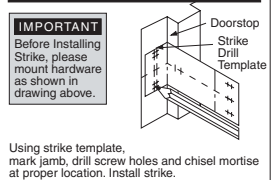

NOTE: Check to ensure face plate does not restrict free movement of the latch head. Install trim.

Repeat instruction 1 - 9 for privacy bolt.

Template #010 - RH

# Installation Instructions for DEAD BOLT T150LP - T151LP - non-bored door condition

## FACE PLATE

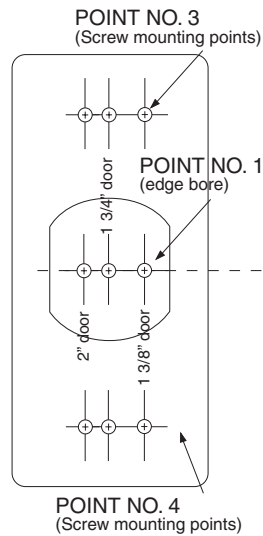

Fold on dotted line - Lay over edge of door.

**IMPORTANT:**  
READ ALL INSTRUCTIONS CAREFULLY  
BEFORE PREPARING DOOR

## DEAD BOLT TEMPLATE

2-3/8" BACKSET TEMPLATE

POINT NO. 2 (face bore)

2-3/4" BACKSET TEMPLATE

## STRIKE TEMPLATE

Fold on dotted line - Lay over edge of door.

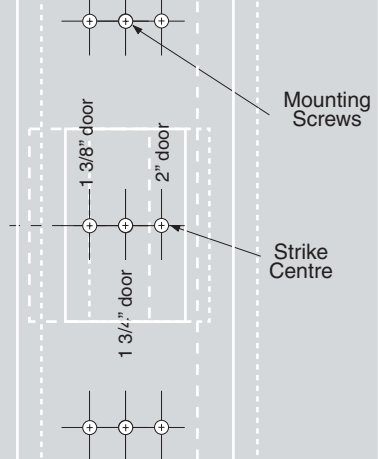

## PARTS INCLUDED WITH YOUR NEW DEAD BOLT

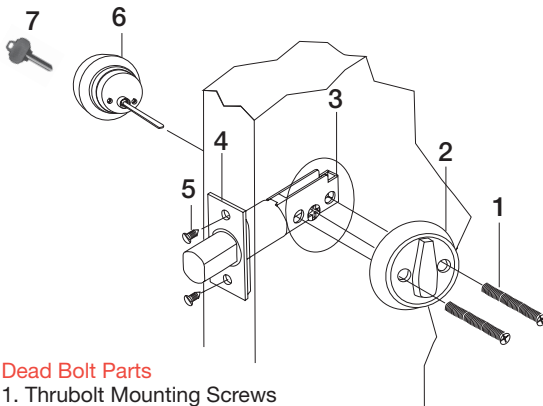

### Dead Bolt Parts

1. Thru-bolt Mounting Screws
2. Inside Thumbturn / Trim
3. Dead Bolt
4. Face Plate
5. Face Plate Screws
6. Outside Cylinder / Trim
7. Key

## Dead Bolt & Strike

### Dead Bolt Strike

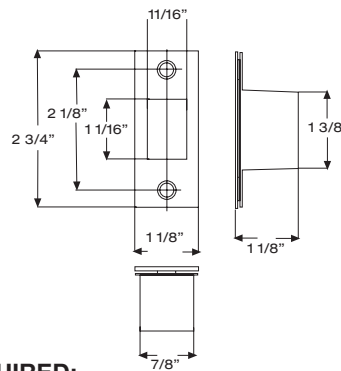

### Dead Bolt

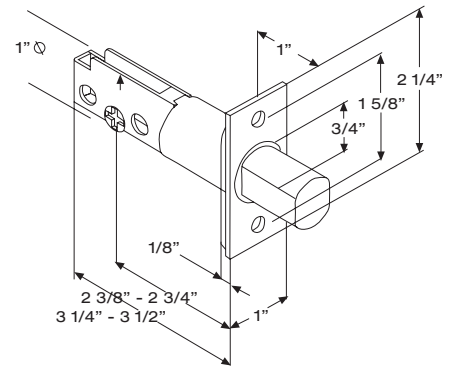

## TOOLS REQUIRED:

Drill, 1 3/4" dia. bit, 1" dia. bit,  
1/8" dia. bit, Center Punch, Chisel, Hammer,  
Phillips Screwdriver.  
**BE SURE TO READ ALL INSTRUCTIONS  
BEFORE PREPARING DOOR.**

### 1. Position Template

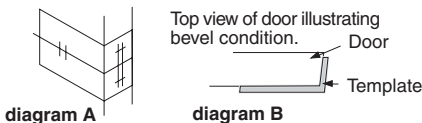

Determine latch backset (2-3/8" or 2-3/4").  
Fold enclosed template on dotted line and locate  
on door at desired height (diagram A).  
If door is beveled (see diagram B), place folded  
edge on low side of bevel as shown above.

### 2. Mark Door

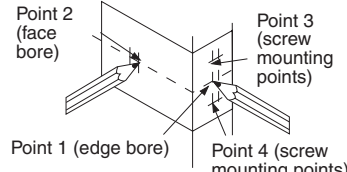

Mark door at points No. 1, No. 2, No. 3,  
and No. 4 and center punch for drilling.

### 3. Drill Edge Bore

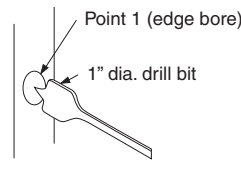

Drill 1" dia. hole.  
2-3/8" backset.... **drill 3-1/2" deep.**  
2-3/4" backset.... **drill 3-3/4" deep.**

### 4. Drill Face Bore

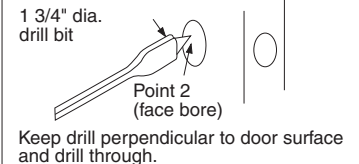

Keep drill perpendicular to door surface  
and drill through.

**Note for wood doors:** to avoid splintering,  
drill a centering hole through the door,  
then drill face bore from both sides.

### 5. Position Faceplate

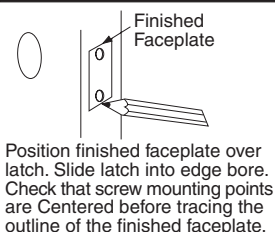

Position finished faceplate over  
latch. Slide latch into edge bore.  
Check that screw mounting points  
are centered before tracing the  
outline of the finished faceplate.

### 6. Chisel Mortise

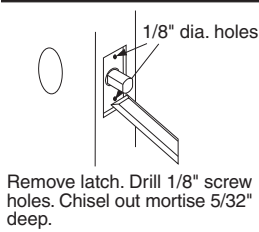

Remove latch. Drill 1/8" screw  
holes. Chisel out mortise 5/32"  
deep.

### 7. Insert Bolt

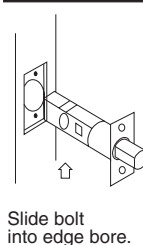

Slide bolt  
into edge bore.

### 8. Attach Faceplate

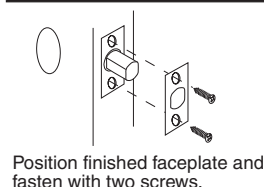

Position finished faceplate and  
fasten with two screws.

### 9. Install Strike

#### IMPORTANT

Before Installing  
Strike, please  
mount hardware  
as shown in  
drawing above.

Using strike template,  
mark jamb, drill screw holes and  
chisel mortise at proper location. Install strike.

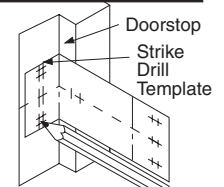

**NOTE:** Check to ensure face plate does not restrict free movement of the bolt head. Install trim.

**Template #003**

## Template for **DOUBLE DUMMY D190** - non-bored door condition

### Determine backset

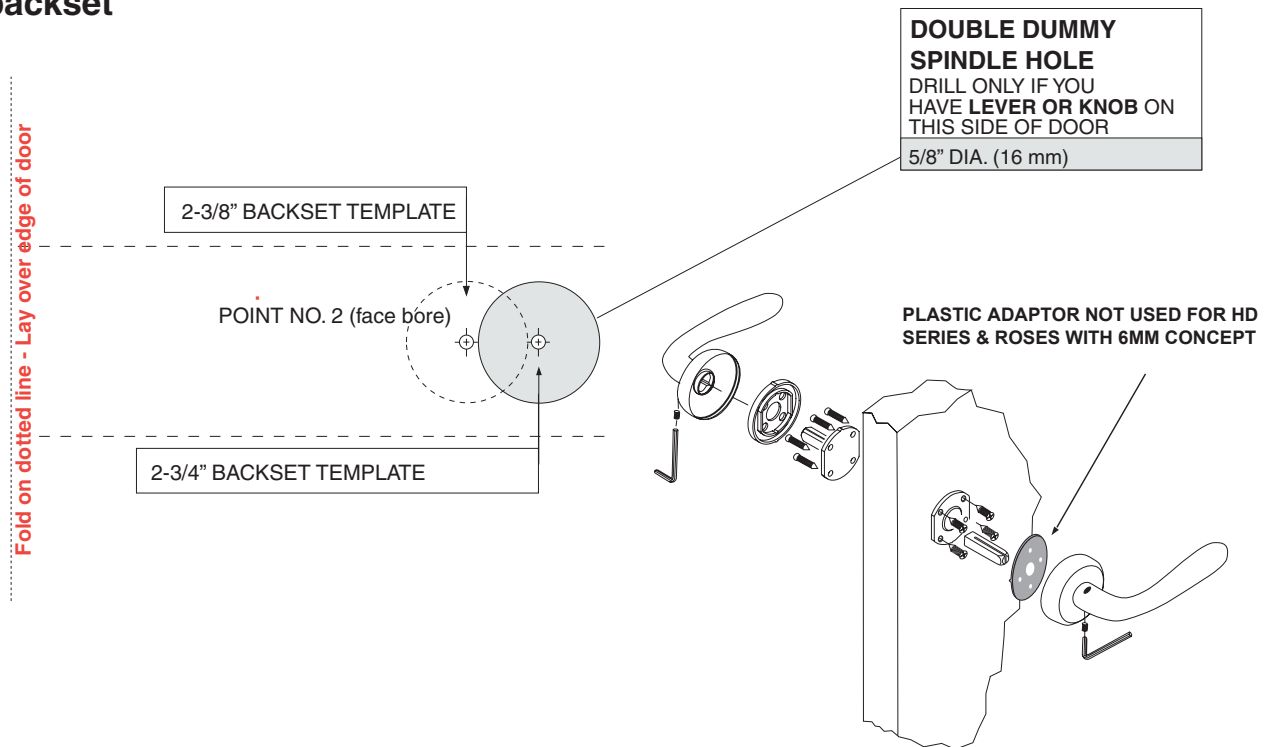

**Template #011A**

## Template for **SINGLE DUMMY D185** - non-bored door condition

### Determine backset

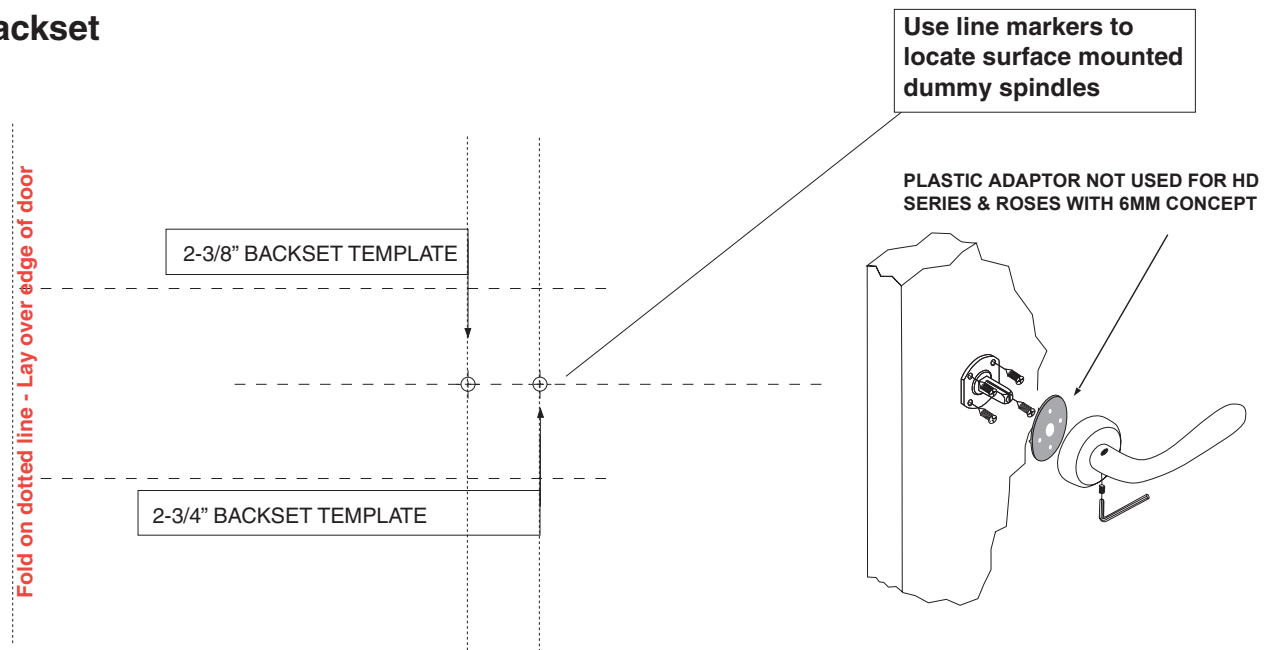

**Template #011B**