

NORTH AMERICAN TUBULAR MOUNTING NA SERIES

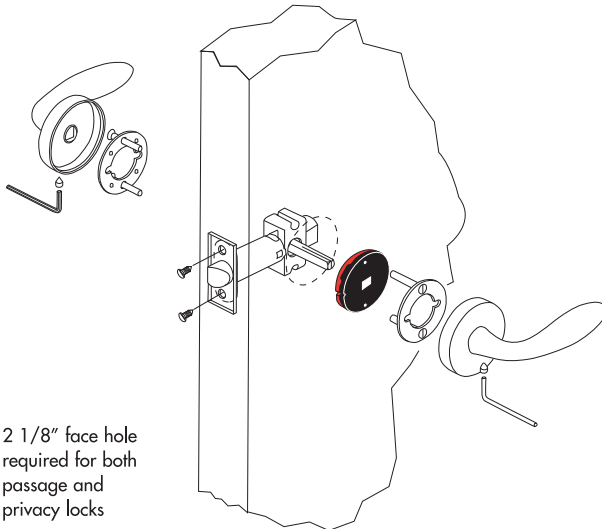

PASSAGE T100 2 3/8" or T101 2 3/4"



Refer to template no. 007

PRIVACY T140 2 3/8" or T141 2 3/4"

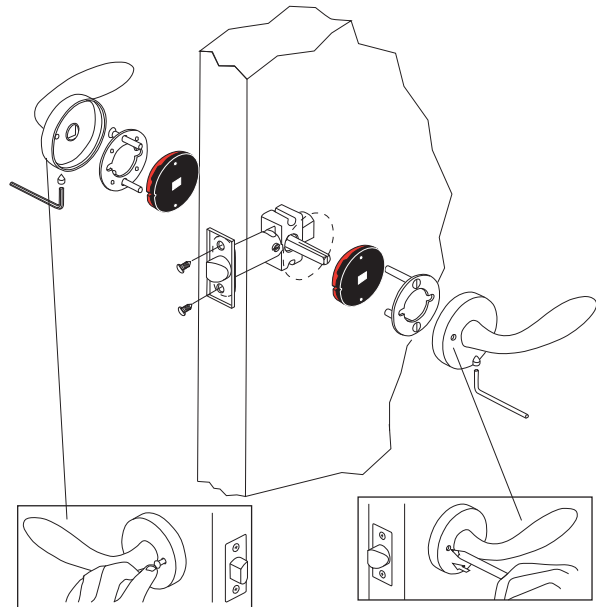

Refer to template no. 008

KEY LOCK T150 2 3/8" or T151 2 3/4"

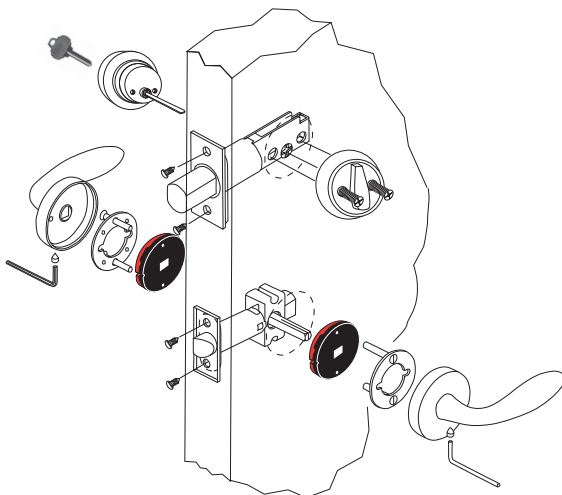

NOTE: T150NA Series Deadbolt used
Refer to template no. 003C for deadbolt only

Sample Specification
For a 2 3/4" Backset Privacy

Lever - CB51 NA - T141 - Satin Nickel

Function ☐ ☐

Finish ☐ ☐

Tubular latches available in 2 3/8" or 2 3/4" back-set. They are NOT adjustable

DOUBLE (FULL) DUMMY D190

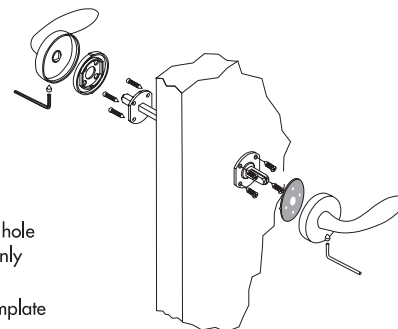

Refer to template
no. 011-A

SINGLE (HALF) DUMMY D185

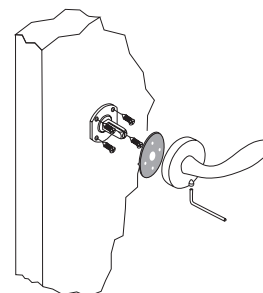

No hole required.
Single dummy spindles
are surface mounted.

Refer to template
no. 011-B

INSTALLATION INSTRUCTIONS FOR PASSAGE LOCK NA T100-T101 - NON BORED DOOR CONDITION

PLEASE NOTE

Required hole positioning

Red side

Black side

Springs are handed. Black must be facing you for Right Hand Lever. Red for Left Hand Lever.

FACE PLATE

POINT NO. 3
(Screw mounting points)

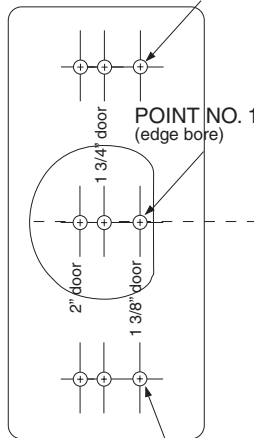

POINT NO. 4
(Screw mounting points)

Fold on dotted line - Lay over edge of door.

IMPORTANT:
READ ALL INSTRUCTIONS CAREFULLY
BEFORE PREPARING DOOR

PASSAGE LATCH TEMPLATE

2-3/8" BACKSET TEMPLATE

POINT NO. 2 (face bore)

2-3/4" BACKSET TEMPLATE

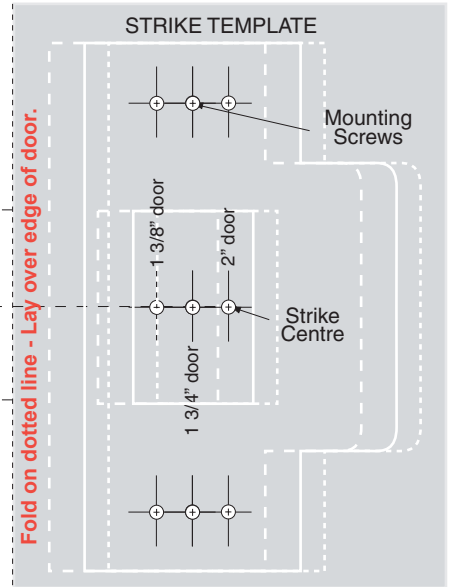

Fold on dotted line - Lay over edge of door.

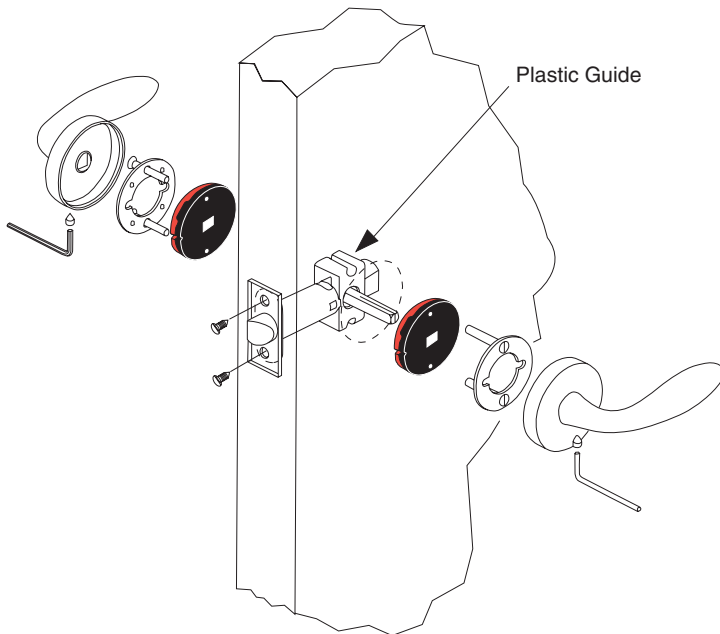

Passage Latch & Strike

Passage Strike

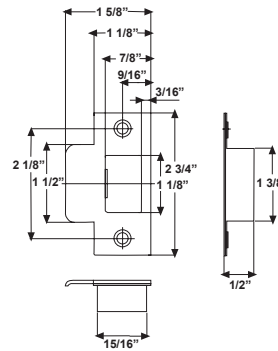

Passage Latch

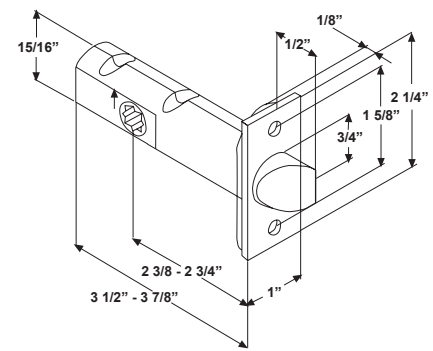

TOOLS REQUIRED:

Drill, 1" dia. bit, 2 1/8" dia. bit, 1/8" dia. bit,
Center Punch, Chisel, Hammer, Phillips Screwdriver.
**BE SURE TO READ ALL INSTRUCTIONS
BEFORE PREPARING DOOR.**

1. Position Template

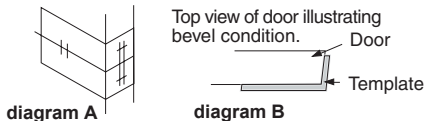

Determine latch backset (2-3/8" or 2-3/4").
Fold enclosed template on dotted line and locate
on door at desired height (diagram A).
If door is bevelled (see diagram B), place folded
edge on low side of bevel as shown above.

2. Mark Door

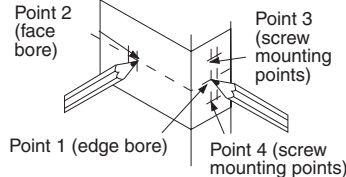

Mark door at points No. 1, No. 2, No. 3,
and No. 4 and center punch for drilling.

3. Drill Edge Bore

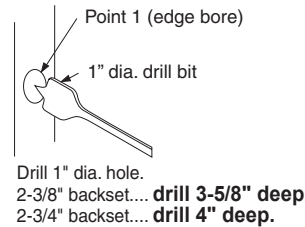

4. Drill Face Bore

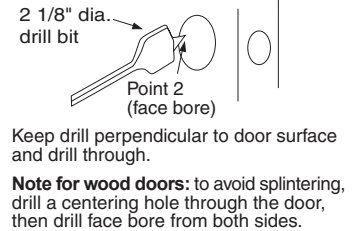

5. Position Faceplate

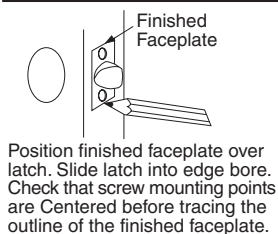

6. Chisel Mortise

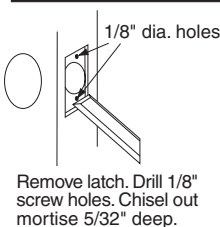

7. Insert Latch

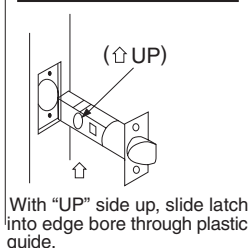

8. Attach Faceplate

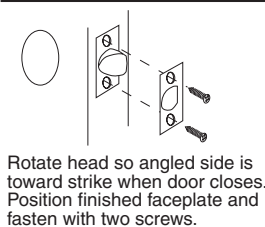

9. Install Strike

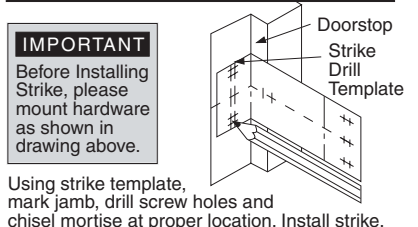

NOTE: Check to ensure face plate does not restrict free movement of the latch head. Install trim.
IMPORTANT - Plastic Guide must be inserted into pre-drilled 2 1/8" hole,
then insert latch through plastic guide. See diagram #7

Template #007-RH

PLEASE NOTE

Required hole positioning

Red side

Black side

Springs are handed. Black must be facing you for Right Hand Lever. Red for Left Hand Lever.

FACE PLATE

POINT NO. 3 (Screw mounting points)

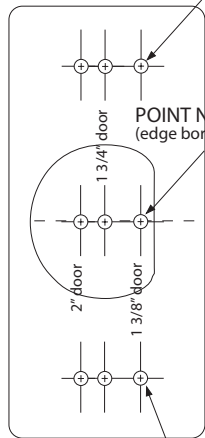

POINT NO. 4 (Screw mounting points)

Fold on dotted line - Lay over edge of door.

IMPORTANT:
READ ALL INSTRUCTIONS CAREFULLY
BEFORE PREPARING DOOR

PRIVACY LATCH TEMPLATE

2-3/8" BACKSET TEMPLATE

POINT NO. 2 (face bore)

2-3/4" BACKSET TEMPLATE

STRIKE TEMPLATE

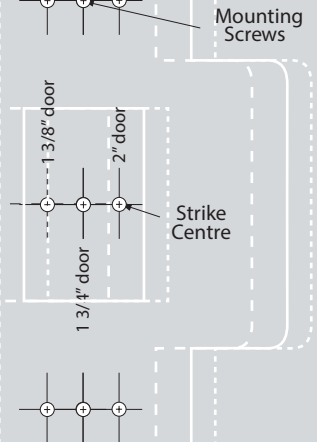

Fold on dotted line - Lay over edge of door.

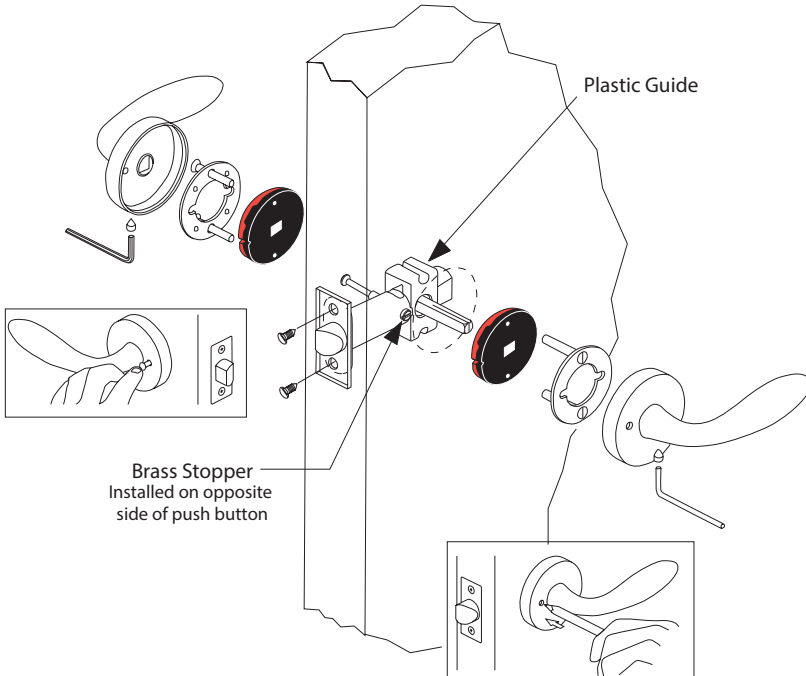

Privacy Latch & Strike

Privacy Strike

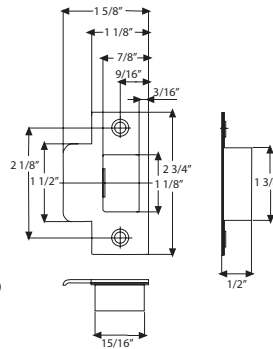

Privacy Latch

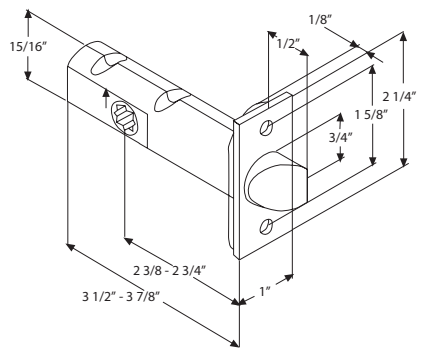

TOOLS REQUIRED:

Drill, 1" dia. bit, 2 1/8" dia. bit, 1/8" dia. bit,
Center Punch, Chisel, Hammer, Phillips Screwdriver.
BE SURE TO READ ALL INSTRUCTIONS
BEFORE PREPARING DOOR.

1. Position Template

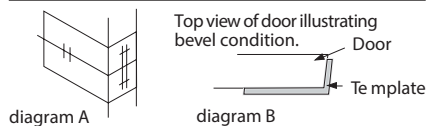

Determine latch backset (2-3/8" or 2-3/4").
Fold enclosed template on dotted line and locate
on door at desired height (diagram A).
If door is bevelled (see diagram B), place folded
edge on low side of bevel as shown above.

2. Mark Door

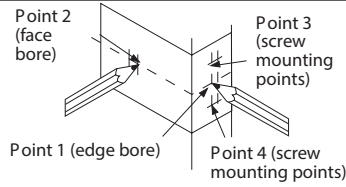

Mark door at points No. 1, No. 2, No. 3,
and No. 4 and center punch for drilling.

3. Drill Edge Bore

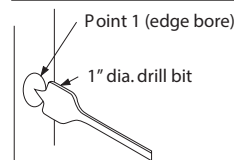

Drill 1" dia. hole.
2-3/8" backset.... drill 3-5/8" deep
2-3/4" backset.... drill 4" deep.

4. Drill Face Bore

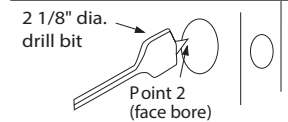

Keep drill perpendicular to door surface
and drill through.
Note for wood doors: to avoid splintering,
drill a centering hole through the door,
then drill face bore from both sides.

5. Position Faceplate

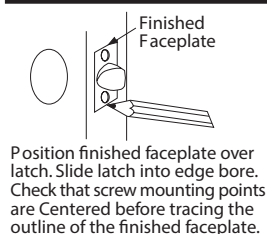

Position finished faceplate over
latch. Slide latch into edge bore.
Check that screw mounting points
are centered before tracing the
outline of the finished faceplate.

6. Chisel Mortise

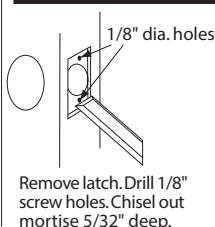

Remove latch. Drill 1/8"
screw holes. Chisel out
mortise 5/32" deep.

7. Insert Latch

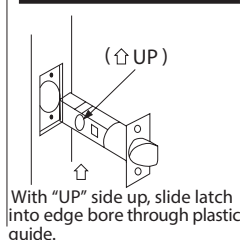

With "UP" side up, slide latch
into edge bore through plastic
guide.

8. Attach Faceplate

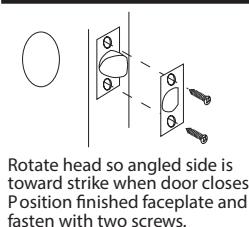

Rotate head so angled side is
toward strike when door closes.
Position finished faceplate and
fasten with two screws.

9. Install Strike

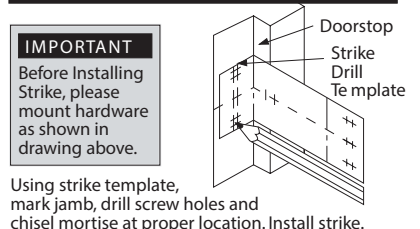

IMPORTANT

Before Installing
Strike, please
mount hardware
as shown in
drawing above.

Using strike template,
mark jamb, drill screw holes and
chisel mortise at proper location. Install strike.

NOTE: Check to ensure face plate does not restrict free movement of the latch head. Install trim.

IMPORTANT - Plastic Guide must be inserted into pre-drilled 2 1/8" hole,
then insert latch through plastic guide. See diagram #7

Installation Instructions for DEAD BOLT T150NA - T151NA - non-bored door condition

FACE PLATE

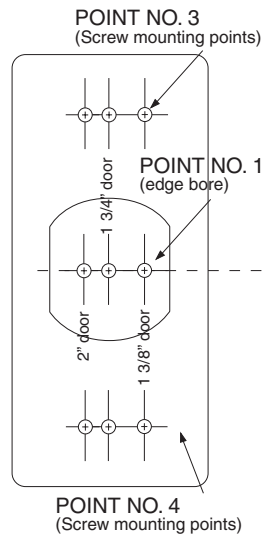

Fold on dotted line - Lay over edge of door.

**IMPORTANT:
READ ALL INSTRUCTIONS CAREFULLY
BEFORE PREPARING DOOR**

DEAD BOLT TEMPLATE

2-3/8\"

POINT NO. 2 (face bore)

2-3/4\"

STRIKE TEMPLATE

Fold on dotted line - Lay over edge of door.

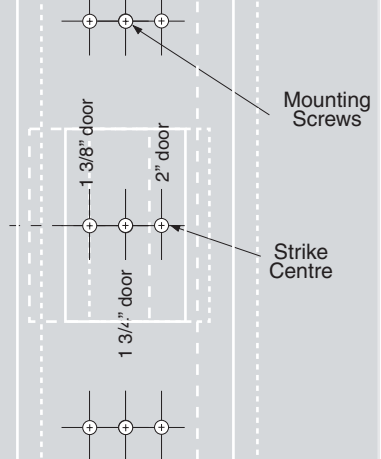

PARTS INCLUDED WITH YOUR NEW DEAD BOLT

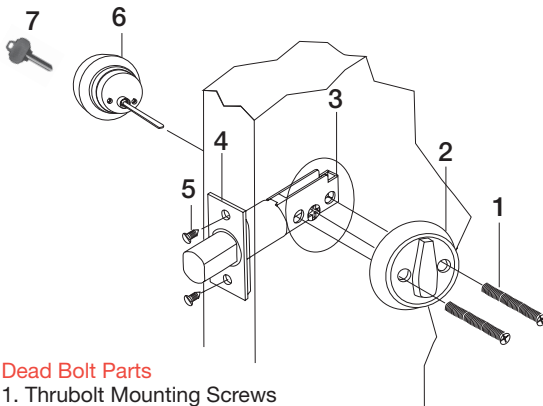

Dead Bolt Parts

1. Thrubolt Mounting Screws
2. Inside Thumbturn / Trim
3. Dead Bolt
4. Face Plate
5. Face Plate Screws
6. Outside Cylinder / Trim
7. Key

Dead Bolt & Strike

Dead Bolt Strike

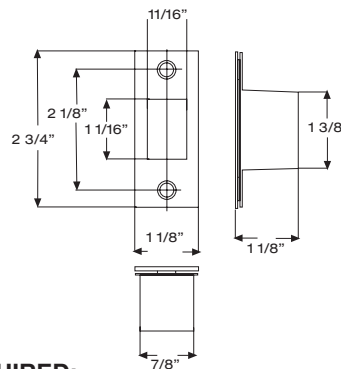

Dead Bolt

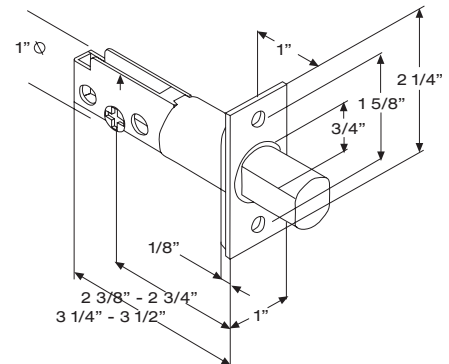

TOOLS REQUIRED:

Drill, 2 1/8\"
1/8\"
**BE SURE TO READ ALL INSTRUCTIONS
BEFORE PREPARING DOOR.**

1. Position Template

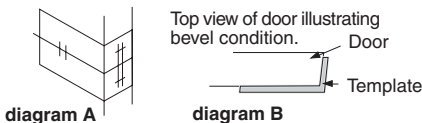

Determine latch backset (2-3/8\"

2. Mark Door

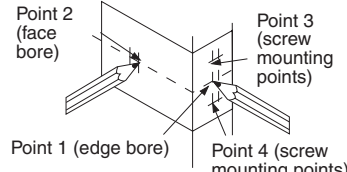

Mark door at points No. 1, No. 2, No. 3, and No. 4 and center punch for drilling.

3. Drill Edge Bore

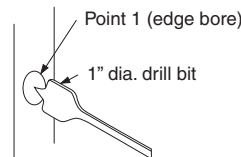

Drill 1\"

4. Drill Face Bore

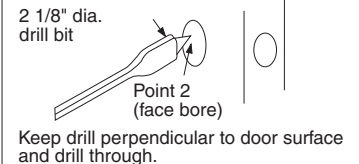

Keep drill perpendicular to door surface and drill through.

Note for wood doors: to avoid splintering, drill a centering hole through the door, then drill face bore from both sides.

5. Position Faceplate

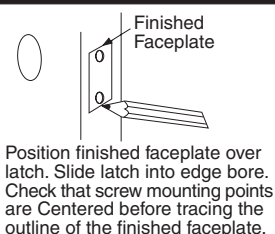

6. Chisel Mortise

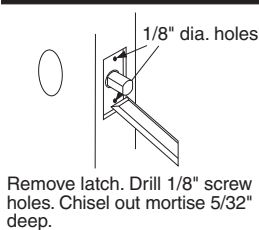

7. Insert Bolt

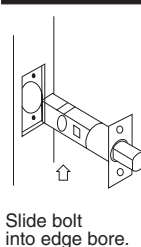

8. Attach Faceplate

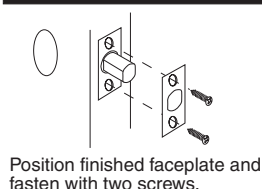

9. Install Strike

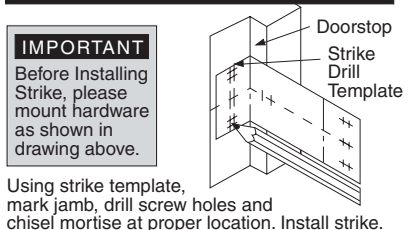

NOTE: Check to ensure face plate does not restrict free movement of the bolt head. Install trim.

Template #003C

Template for **DOUBLE DUMMY D190** - non-bored door condition

Determine backset

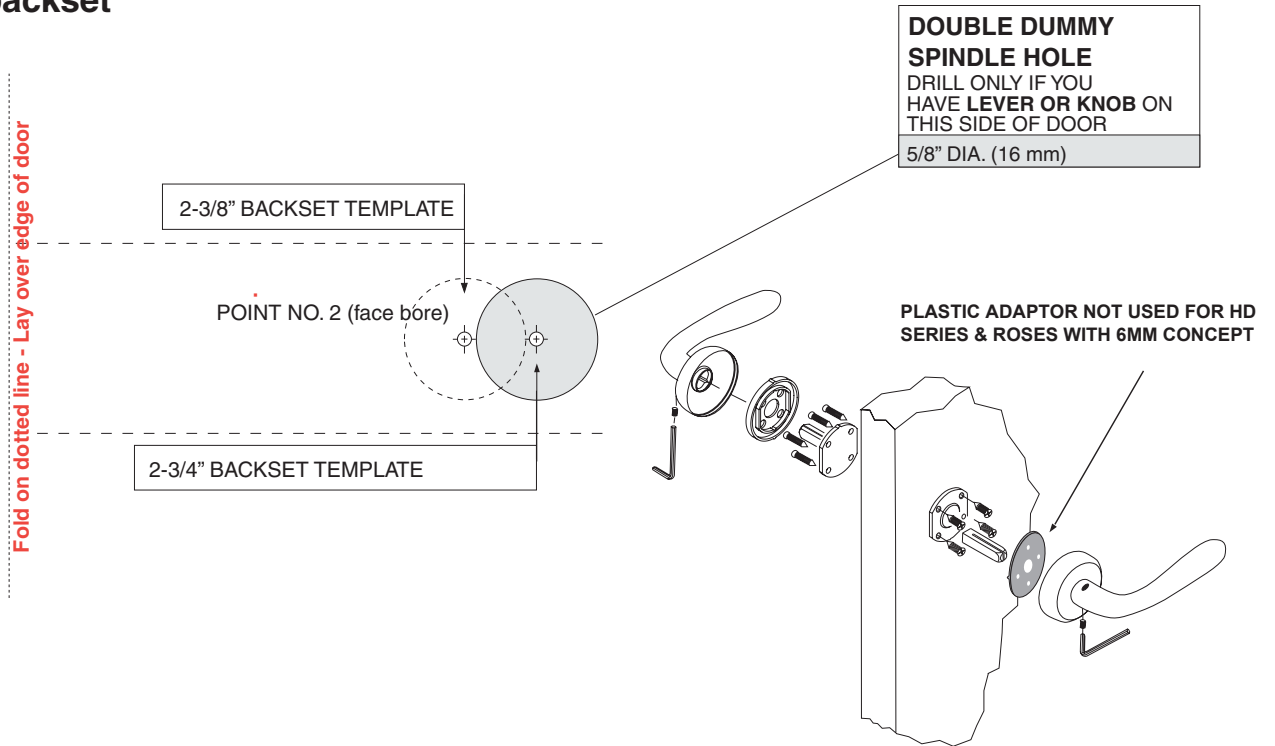

Template #011A

Template for **SINGLE DUMMY D185** - non-bored door condition

Determine backset

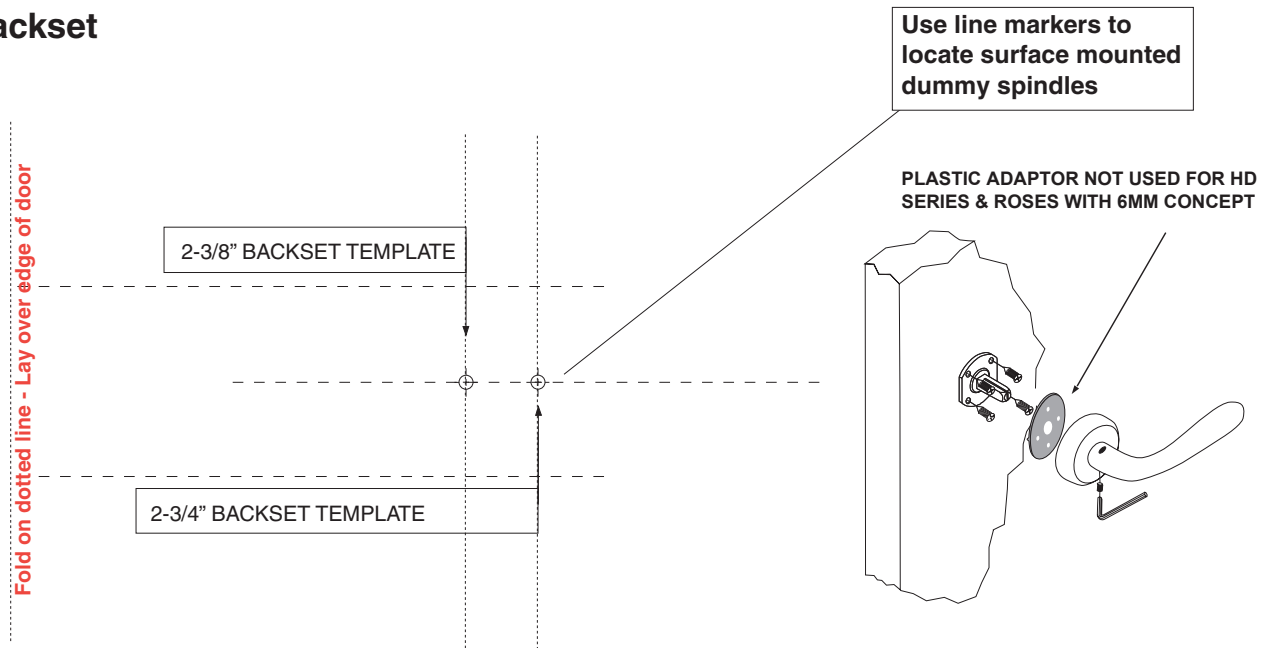

Template #011B